



# AV TRANSPARENCY KIT

## TRANSLATION OF THE ORIGINAL INSTRUCTIONS

This manual is covered by Copyright, all rights are reserved; as such reproduction or release, even partial, of the contents are prohibited without the prior written authorization of Antares Vision.

All the information has been drawn up to ensure a rational and efficient working of the software in question.

Some functions of the software can be customized according to your specific needs.

This manual may therefore contain explanations for features not available in your installation.

The images contained in this document are for illustration purposes only and may not match your installation.

**VERSION OF THE MANUAL**

| SUM VERS. | SOFTWARE VERS. | DATE       | ISSUE                             |
|-----------|----------------|------------|-----------------------------------|
| 00        | 00             | 15/06/2020 | First Edition AV Transparency Kit |

## SUMMARY

|                                 |    |
|---------------------------------|----|
| <b>INTRODUCTION</b>             | 5  |
| <b>GLOSSARY AND CONVENTIONS</b> | 6  |
| SYMBOLS AND CONVENTIONS         | 7  |
| <b>ACCESS</b>                   | 8  |
| LOGIN PANEL                     | 8  |
| <b>INTERFACE STRUCTURE</b>      | 9  |
| HOME PAGE INTERFACE             | 9  |
| NAVIGATION MENU                 | 9  |
| UPPER BAR                       | 10 |
| INTERFACE ELEMENTS              | 11 |
| NOTIFICATIONS                   | 12 |
| ADAPTIVE INTERFACE              | 13 |
| <b>WORKORDER LIST</b>           | 14 |
| WORKORDER OPTIONS PANEL         | 15 |
| ACTION BUTTONS                  | 15 |
| CREATE WORKORDER                | 16 |
| WORKORDER DETAIL PAGE           | 17 |
| CLOSE WORKORDER                 | 19 |
| <b>START AGGREGATION</b>        | 20 |
| VERIFY PAGE                     | 21 |
| <b>IDENTIFY PAGE</b>            | 22 |
| REJECTED ITEM                   | 23 |
| SHOW PARENT                     | 23 |
| <b>NOTES</b>                    | 24 |

---

## **INTRODUCTION**

AV Transparency Kit is an industrywide, retailer agnostic service developed by Antares Vision that proactively helps brands improve transparency of products at consumer level.

## GLOSSARY AND CONVENTIONS

| ACRONYM      | MEANING                    |
|--------------|----------------------------|
| <b>AV</b>    | Antares Vision             |
| <b>GTIN</b>  | Global Trade Item Number   |
| <b>FW</b>    | Firmware                   |
| <b>HW</b>    | Hardware                   |
| <b>IP</b>    | Internet Protocol          |
| <b>IQ</b>    | Installation Qualification |
| <b>NTIN</b>  | National Trade Item Number |
| <b>N/A</b>   | Not Applicable             |
| <b>SGTIN</b> | S Global Trade Item Number |
| <b>SW</b>    | Software                   |
| <b>QA</b>    | Quality Assurance          |
| <b>WO</b>    | Workorder                  |



The red arrow indicates a specific point mentioned in the text within an image (flags, parameters, buttons, etc.).



The red box defines an area or part of an image mentioned in the text (parameter lists, defined sections, etc.).



The red box defines an area or part of an image mentioned in the text (parameter lists, defined sections, etc.).

**INFO:** This chapter describes all the features of the software, however some may differ based on customer customisation requests.

**INFO:** The images are for illustration purposes only. The software screen may differ according to the customer's customisation requests.

## • SYMBOLS AND CONVENTIONS

Numbered indicators are used in this manual to identify the relevant and dynamic elements of the interface. After being numbered, these elements are described in specific tables.



| ID | Element Name | Description           |
|----|--------------|-----------------------|
| 1  | Example      | Detailed description. |
| X  | Example      | Detailed description. |

In the software interface, pages or elements opened by a button or a certain action are numbered with a red indicator bearing the same number as the command that generated them (see example below). The opened image/interface is consequently outlined in red. In addition to the open pages, this graphic is also used to zoom or see certain page elements in detail.

The example shows how, by pressing button A, a new software page opens, numbered indeed with a red indicator and a white number A.

The same principle also applies to field number X, shown below in a new numbered image with a red indicator and a white number X.

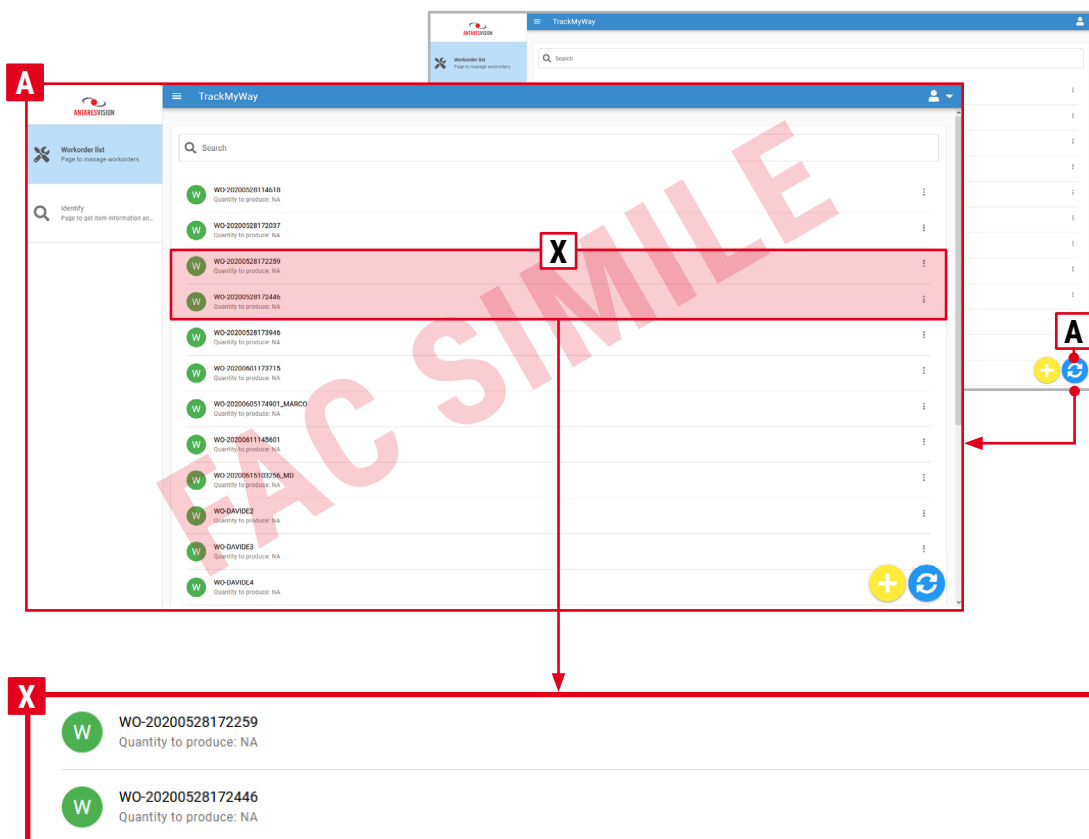

**INFO:** This chapter describes all the features of the software, however some may differ based on customer customisation requests.

**INFO:** The images are for illustration purposes only. The software screen may differ according to the customer's customisation requests.

## ACCESS

- LOGIN PANEL

When the application is started, the LogIn page opens.

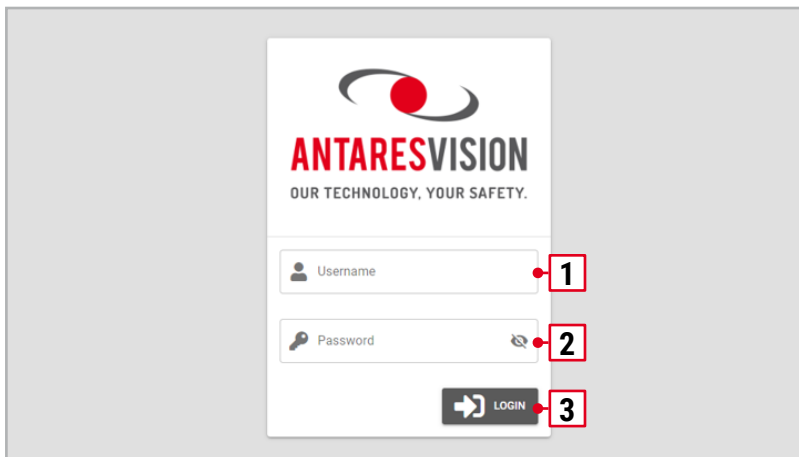

1. AV Transparency Kit / Login Panel

When the Login data is entered, press the Login button (3) to access the main software page.

| ID | Field Name      | Description   |
|----|-----------------|---|
| 1  | <b>Username</b> | This is to enter the user name.   |
| 2  | <b>Password</b> | This is to enter the Password.  |
| 3  | <b>Login</b>    | After correctly completing Username (1) and Password (2) text fields press this to access the system. |

**WARNINGS:** Both Username (1) and Password (2) are CASE SENSITIVE.

**INFO:** This chapter describes all the features of the software, however some may differ based on customer customisation requests.

**INFO:** The images are for illustration purposes only. The software screen may differ according to the customer's customisation requests.



## INTERFACE STRUCTURE

### • HOME PAGE INTERFACE

The software interface of AV Transparency Kit is composed of an upper bar (U), a navigation menu (NM) located on the left side of the interface and a central workspace.

From this interface, the user can:

- Access the workorders list;
- Identify any code to check its status and aggregation details.

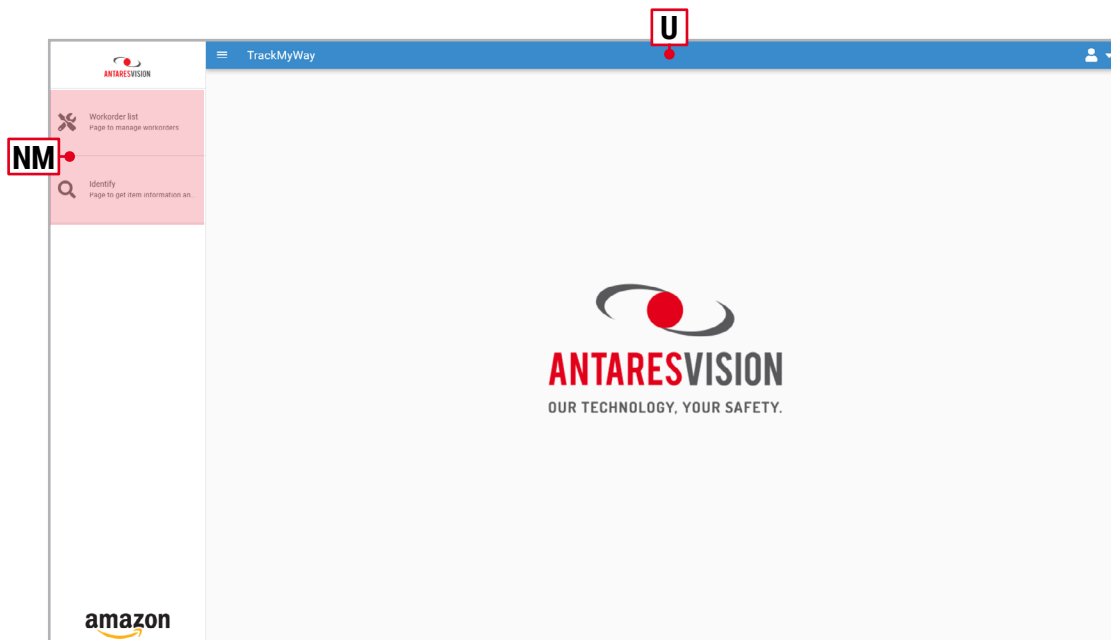

2. AV Transparency Kit / Home Page Interface

### • NAVIGATION MENU

On the left side of the interface of AV Transparency Kit there is the navigation menu.

The navigation menu (NM) allows the user to navigate through the software pages. Every page of the software is represented by a tile that contains the icon, the name and a short description of the related section.

| ID        | Field Name             | Description  |
|-----------|------------------------|--|
| <b>B</b>  | <b>Upper Bar</b>       | The upper bar shows the name of the software and contains the Menu and User Settings buttons.  |
| <b>NM</b> | <b>Navigation Menu</b> | The navigation menu allows the user to navigate through the software pages. Every page of the software is represented by a tile that contains the icon, the name and a short description of the related section. |

**INFO:** This chapter describes all the features of the software, however some may differ based on customer customisation requests.

**INFO:** The images are for illustration purposes only. The software screen may differ according to the customer's customisation requests.

## • UPPER BAR

At the top of the interface there is the navigation bar.

This bar shows the name of the product (N) and allows the user to open or close the navigation menu or to open the User Settings Panel (US).

The Menu Button (M) allows the user to switch the Navigation Menu between extended and slim mode.

In extended mode, the menu shows the icon, the name and a quick description of the software page related to the tile.

In slim mode, the menu shows only the icon of the page/tile, without the related name.

The "User" button (U) allows the user to open or close the User Settings Panel (US). This panel shows the name and the image of the current User (CU). Here, the user can also set the System Language (L) or Logout (LO).



3. AV Transparency Kit / Upper Bar

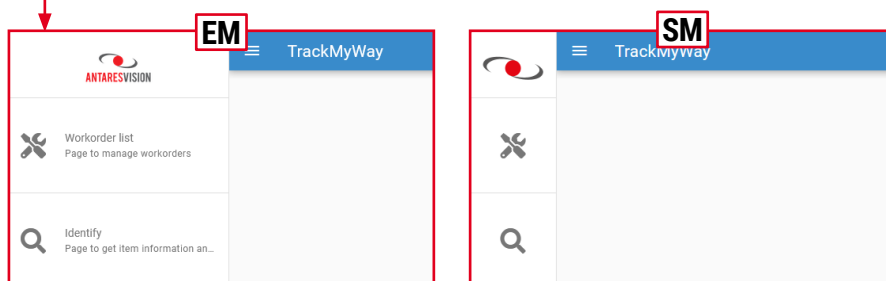

5. AV Transparency Kit / Navigation Menu, Extended and Slim Versions

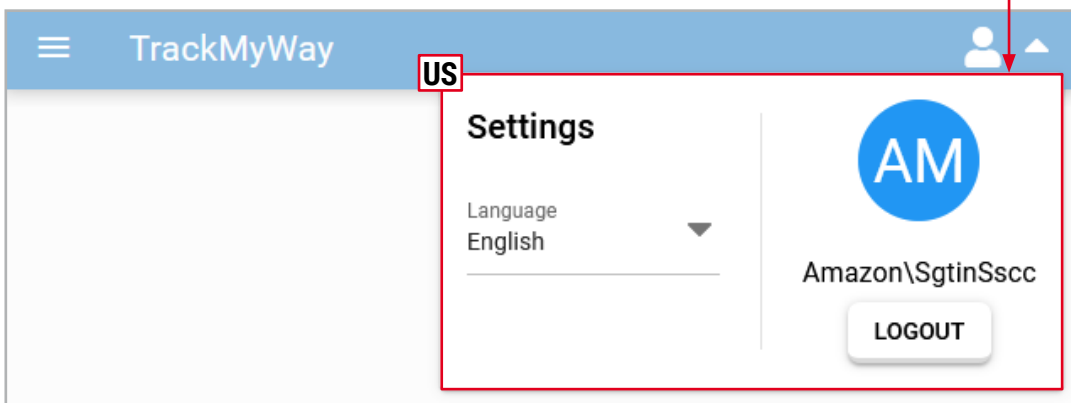

4. AV Transparency Kit / User Settings Panel

| ID | Field Name          | Description   |
|----|---------------------|---|
| N  | Product Name        | The upper bar shows the name of the "" product.   |
| M  | Menu Button         | The Menu Button (M) allows the user to switch the Navigation Menu between extended (EM) and slim mode (SM).                                 |
| U  | User Button         | The "User" button (U) allows the user to open or close the User Settings Panel (US).  |
| US | User Settings Panel | This panel shows the name and the image of the current User (CU). Here, the user can also set the System Language (L) or doing Logout (LO). |

## • INTERFACE ELEMENTS

The " AV Transparency Kit" software interface is very simple and friendly, in the next image all the main element are explained.

Besides the upper bar (B) and the navigation menu (NM) explained in the previous page, the interface is composed of a workspace divided in "cards" or "sections". The card in the upper side (C) of the interface is used to insert data or to execute some software action.

The card in the lower side (W) is called a "work card". It is tailored to the software function that the user has selected in the navigation menu (NM)

In the lower right corner corner of the interface there are the Action Buttons (A). This button allows the user to interact with the software or with the elements included in the workcard. In the lower left corner there is the Customer's Logo (L).

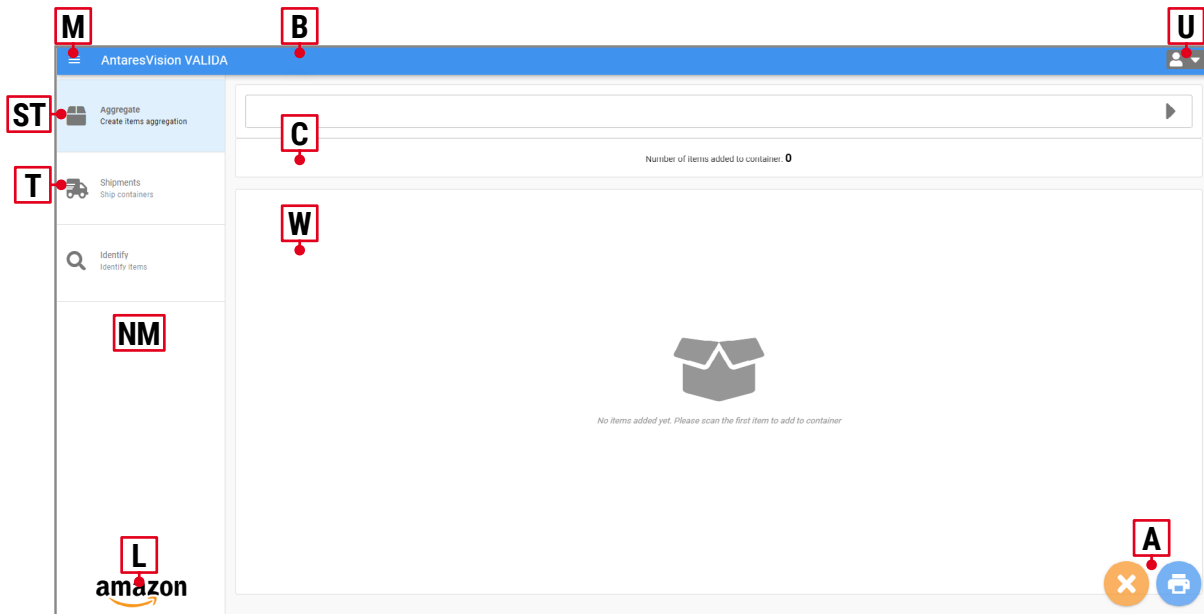

6. AV Transparency Kit / Interface Elements

| ID        | Field Name             | Description  |
|-----------|------------------------|--|
| <b>B</b>  | <b>Upper Bar</b>       | The upper bar shows the name of the software and contains the Menu (M) and User Option (U) buttons.  |
| <b>M</b>  | <b>Menu Button</b>     | This button allows the user to switch the navigation menu between silm and extendend menu.   |
| <b>NM</b> | <b>Navigation Menu</b> | The navigation menu allows the user to navigate through the software pages. Every page of the software is represented by a tile that contains the icon, the name and a short description of the related section. |
| <b>T</b>  | <b>Tile</b>            | It represent and allows to open a section of the software. If not selected, the tile is white with grey icon and texts.  |
| <b>ST</b> | <b>Selected Tile</b>   | It represent the current opened section of the software. The user can recognize it because, when selected, it becomes light blue.  |
| <b>U</b>  | <b>User Options</b>    | This button allows the user to open or close the User Settings Panel (US).   |
| <b>L</b>  | <b>Customers Logo</b>  | Customer's Logo  |
| <b>C</b>  | <b>Immision Card</b>   | The work card on the upper side of the interface is usually used to insert data or codes in the software. In other case, this card contain commands realated to the software elements.                           |
| <b>W</b>  | <b>Work Card</b>       | The work card in the lower side of the interface is tailored to the software function that the user has selected in the navigation menu (NM).  |
| <b>A</b>  | <b>Action Buttons</b>  | These buttons are the most widely used command that allow the user to interact with the software.  |

## • NOTIFICATIONS

Software notifications will be communicated by colored tiles that scroll from top to bottom (newer notifications are at the top, while older notifications are at the bottom). The type of notification will be associated with a specific color. Each notification tile will also include an icon and a description.

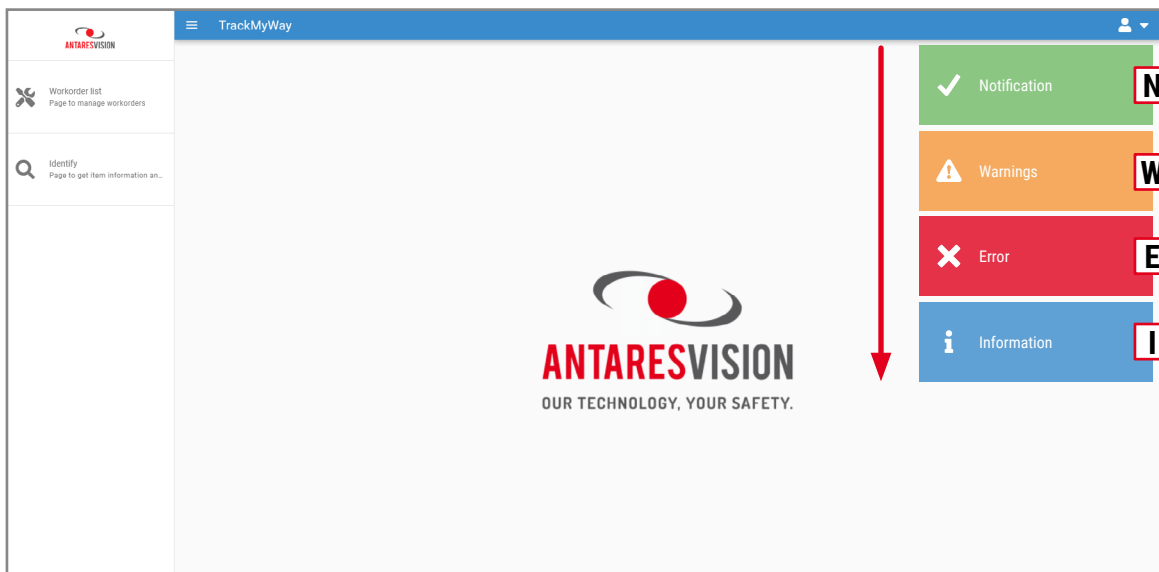

7. AV Transparency Kit / Notifications

| ID       | Field Name          | Description  |
|----------|---------------------|--|
| <b>N</b> | <b>Notification</b> | This Green colored tile appears every time there is a system notification.   |
| <b>W</b> | <b>Warning</b>      | This Yellow colored tile appears every time there is a warning in the work processed that needs user attention.<br>Warning will allow the user to continue whatever they are addressed or not. |
| <b>X</b> | <b>Error</b>        | This Red colored tile appears every time there is an error in the work processed that needs user attention.<br>Errors will not allow the user to continue until they are addressed.            |
| <b>I</b> | <b>Information</b>  | This light blue colored tile appears to show the user some information about the work processes.   |

**INFO:** This chapter describes all the features of the software, however some may differ based on customer customisation requests.

**INFO:** The images are for illustration purposes only. The software screen may differ according to the customer's customisation requests.

## • ADAPTIVE INTERFACE

The interface dimensions can be resized as desired by the user. The elements of the page automatically adapt their the size depending on the device used. This allows the user to easily use "AV Transparency Kit" on Smarthphone or other devices.

The mechanics and functions of the interface remains unchanged. The only difference concerns the size of the elements and buttons that automatically adapt their size to the size of the device used by the user.

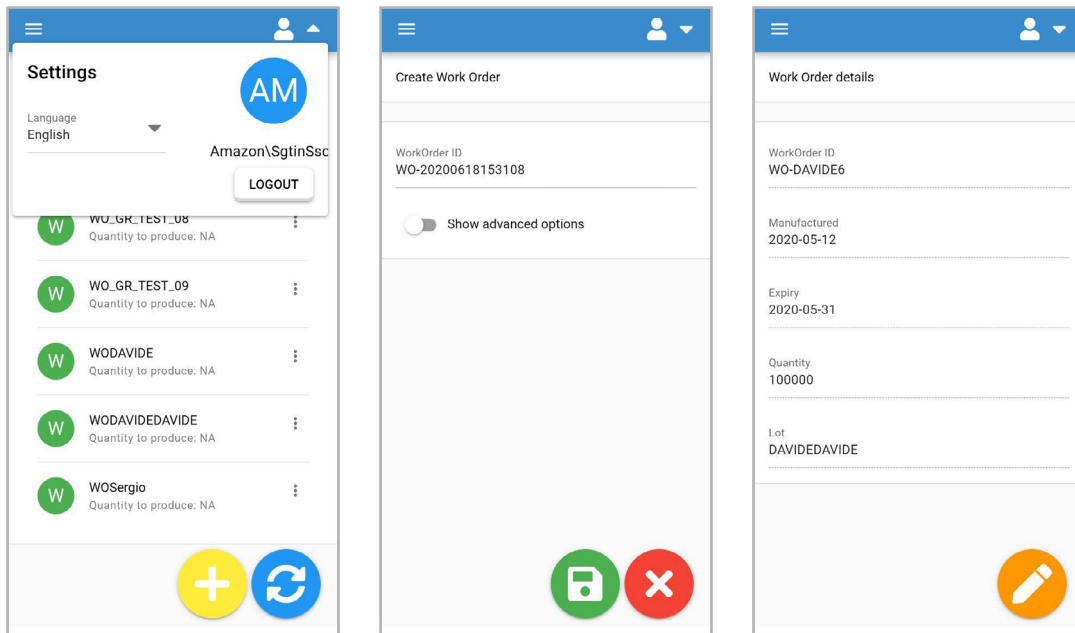

8. AV Transparency Kit / Adaptive Interface / Example

**INFO:** This chapter describes all the features of the software, however some may differ based on customer customisation requests.

**INFO:** The images are for illustration purposes only. The software screen may differ according to the customer's customisation requests.

## WORKORDER LIST

In the navigation menu, select the tile "Workorder List" (W) to access the related page.

The Workorder List Page lists all the production order that are not yet closed. and allows the user to interact whit them.  
This page allows the user to:

- Create or Close a new Workorder
- Show Workorder Details
- Close a Workorder

When an order is closed, its aggregation data is automatically communicated to Amazon.

Every workorder corrsiponds to a line of the page that includes a colored icon that shows its status, the code and the quantity to produce.  
Using the "Options Button" (O) on the right side of the line, or directly pressing on a Workorder, an options panel appears (image WL).

In the lower right corner corner of the interface there are the Action Buttons (A). This buttons allows the user to interact with the page elements.

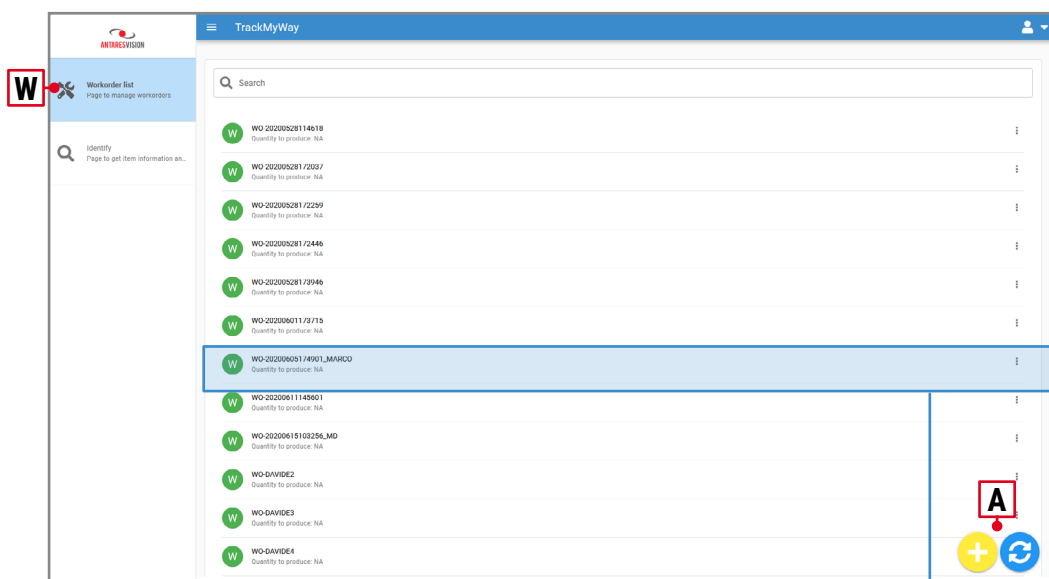

9. AV Transparency Kit / Workorder List / Main

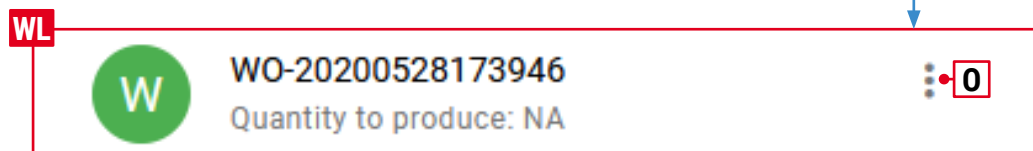

10. AV Transparency Kit / Workorder List / Workorder

| ID | Field Name     | Description   |
|----|----------------|---|
| O  | Options        | This button allows the user to open the Workorder Options Panel.  |
| A  | Action Buttons | These buttons allows the user to interact with the page elements. |

**INFO:** This chapter describes all the features of the software, however some may differ based on customer customisation requests.

**INFO:** The images are for illustration purposes only. The software screen may differ according to the customer's customisation requests.

## • WORKORDER OPTIONS PANEL

In the Workorder List Page, by clicking on a workorder (or using the "Options Button"), an Options Panel (OP) will appear where the user can get more info on the work order, start the aggregation or close it.

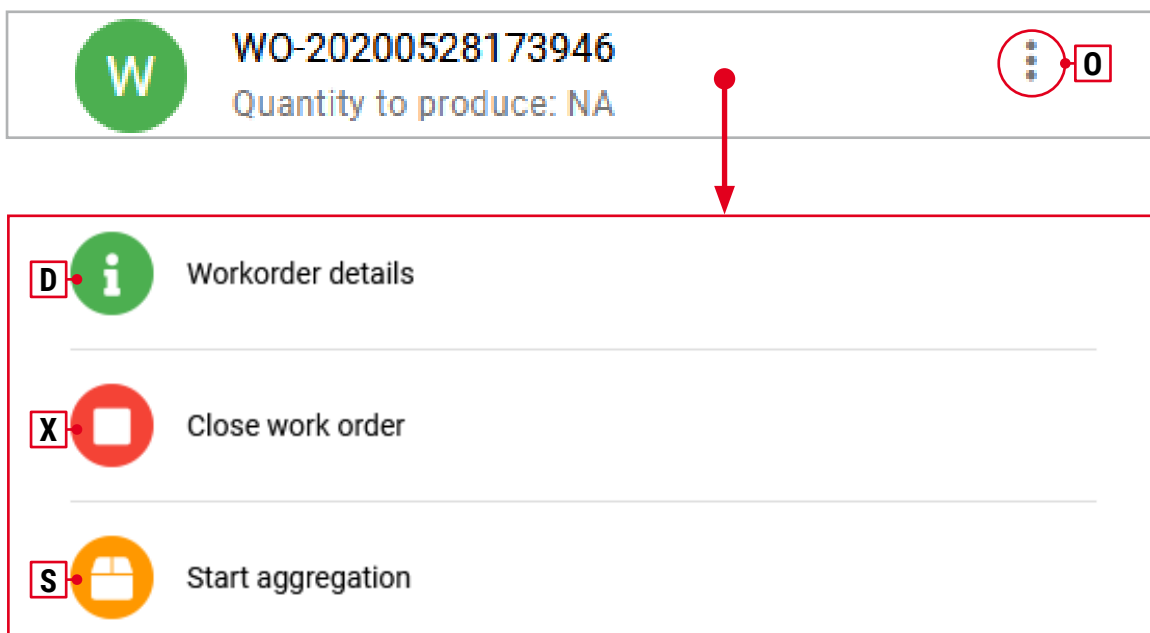

11. AV Transparency Kit / Workorder List / Workorder Options Panel

## • ACTION BUTTONS

In the lower right corner corner of the interface there are the Action Buttons (A). This button allows the user to interact with the page elements.

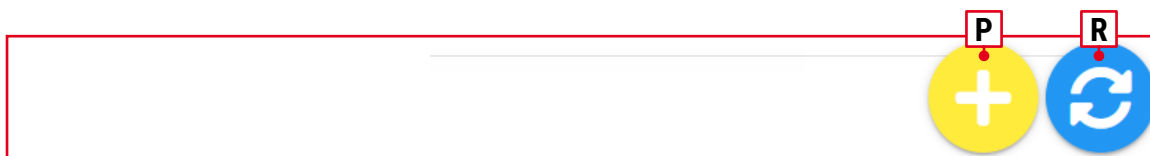

12. AV Transparency Kit / Workorder List / Workorder Options Panel / Action Buttons

| ID | Field Name         | Description  |
|----|--------------------|--|
| D  | Workorders Details | This button allows the user to open the Workorder Detail Page.   |
| X  | Close Workorders   | This button allows the user to Close the selected Workorder  |
| S  | Start Aggregation  | This button allows the user to start the aggregation for the selected work order or to continue the one currently in progress. |
| P  | Create Workorder   | This button allows the user to Create a New Workorder.   |
| R  | Refresh            | This button allows the user to refresh the page and update its data.   |

## • CREATE WORKORDER

In the "Workorder List" page, press the "Create Workorder" button to open the related page.

Here, the user can create a new workorder by editing the data field of the page.

The "Show Advanced Option" (SA) switch allows the user to show Advanced parameters. If the user doesn't insert this parameters the system inserts default parameters. The user can open this menu and modify this fields in every moment.

In particular the page shows:

- **Lot** - Mandatory, as defined in GS1 standards;
- **Expiry** - Optional, as defined in GS1 standards;
- **Packaging Line** - Optional Alphanumeric, variable length up to 50 characters;
- **Manufacturing Location** - Optional Alphanumeric, variable length up to 50 characters;
- **Facility Type** - Optional Alphanumeric, variable length up to 50 characters;
- **Ship to** - Optional Alphanumeric, variable length up to 50 characters.

After inserting the data, the user can save the Workorder by pressing the Save Button (S) or cancel the operation by pressing the Cancel Button (X).

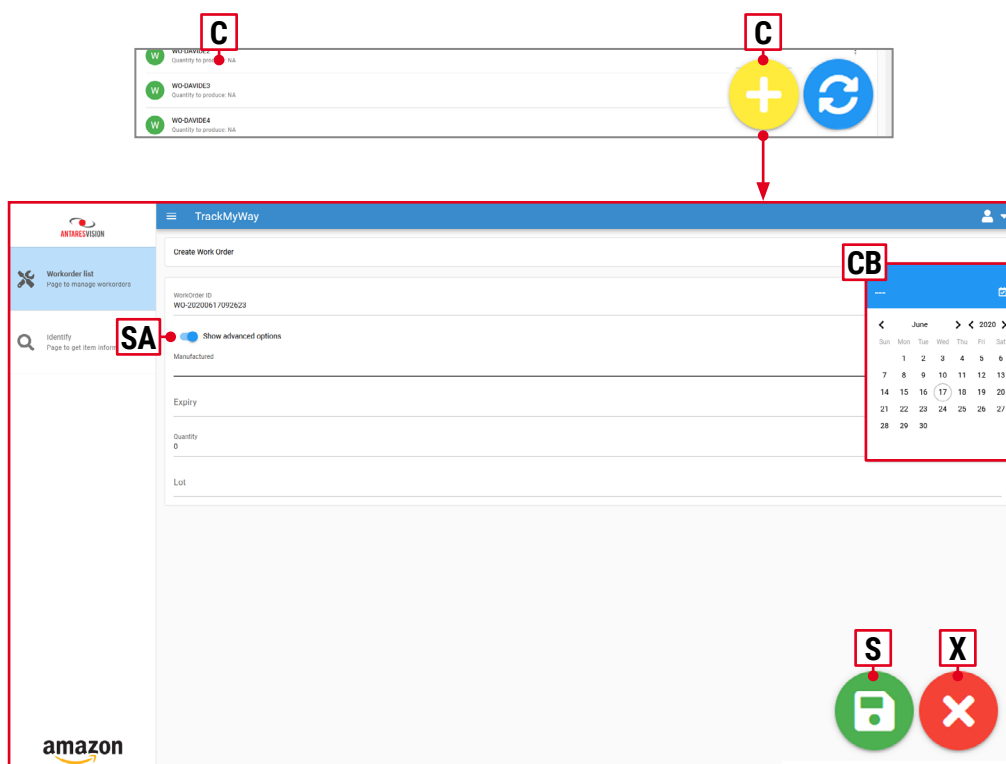

13. AV Transparency Kit / Workorder List / Workorder Detail Page

| ID        | Field Name              | Description   |
|-----------|-------------------------|---|
| <b>C</b>  | <b>Create Workorder</b> | This button allows the user to open the New Workorder page.                                 |
| <b>CB</b> | <b>Calendar Panel</b>   | This button opens a smart calendar that allows the user to quickly select the desired data. |
| <b>S</b>  | <b>Save Button</b>      | This button allows the user to save the Workorder   |
| <b>X</b>  | <b>Cancel Button</b>    | This button allows the user to cancel the operation and return to the Workorder Main Page.  |

**INFO:** This chapter describes all the features of the software, however some may differ based on customer customisation requests.

**INFO:** The images are for illustration purposes only. The software screen may differ according to the customer's customisation requests.



## • WORKORDER DETAIL PAGE

In the "Workorder List" page, after opening the Options Panel (O), and pressed the button (D) to open the Workorder Detail Page. The Workorder Detail page shows the workorder data, in particular:

- **Lot** - Mandatory, as defined in GS1 standards;
- **Expiry** - Optional, as defined in GS1 standards;
- **Packaging Line** - Optional Alphanumeric, variable length up to 50 characters;
- **Manufacturing Location** - Optional Alphanumeric, variable length up to 50 characters;
- **Facility Type** - Optional Alphanumeric, variable length up to 50 characters;
- **Ship to** - Optional Alphanumeric, variable length up to 50 characters.

Pressing the "Edit" button (E) the system shows the "Edit Workorder" page, where the user can modify the data.

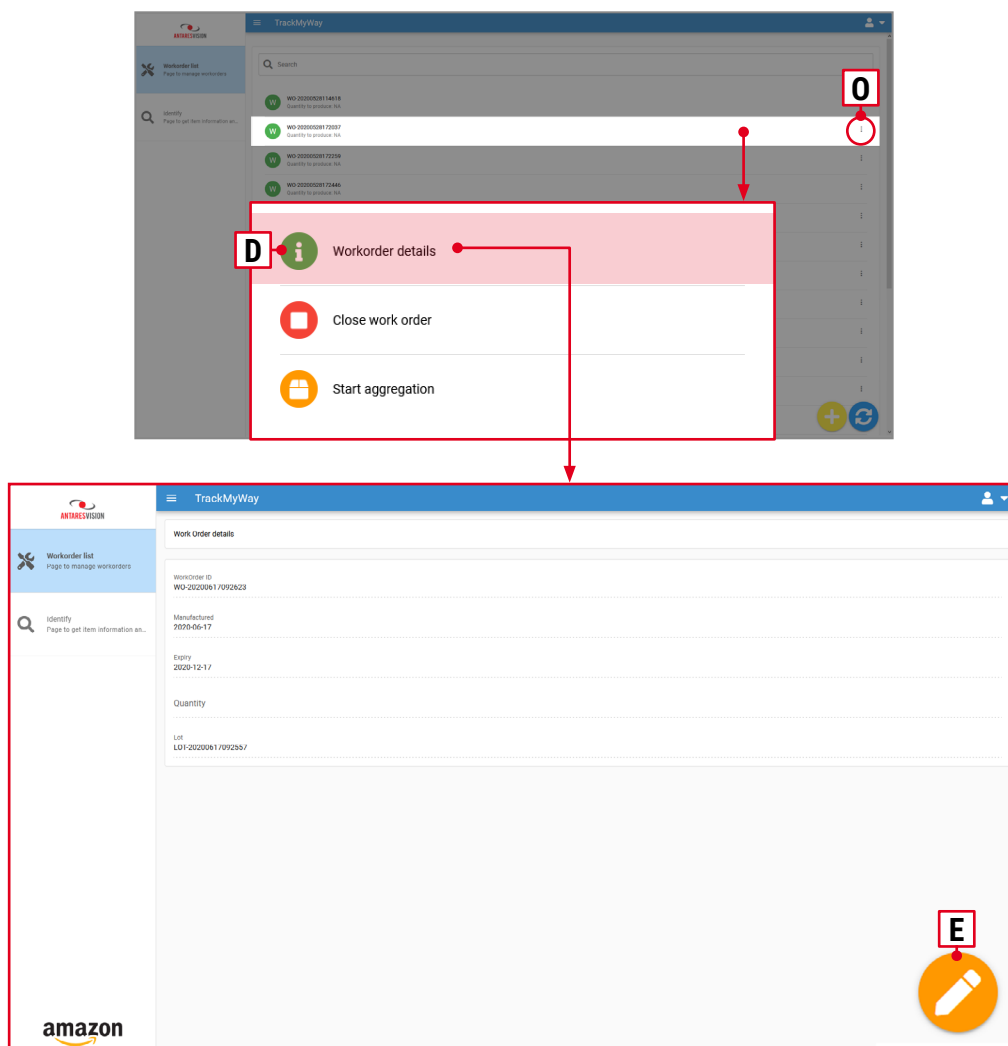

14. AV Transparency Kit / Workorder List / Workorder Detail Page

| ID | Field Name            | Description  |
|----|-----------------------|--|
| E  | <b>Edit Workorder</b> | This button allows the user to open the "Edit Workorder" page, where the user can modify the data. |

**INFO:** This chapter describes all the features of the software, however some may differ based on customer customisation requests.

**INFO:** The images are for illustration purposes only. The software screen may differ according to the customer's customisation requests.

## » EDIT WORKORDER

In the "Workorder List" page, press the "Edit Workorder" button to open the related page.

This page is very similar to the "Create Workorder Page". Here, the user can modify the workorder by edit the data field of the page. The "Show Advanced Option" (SA) switch allows the user to open the menu an show more data about the current Workorder.

After inserting the data, the user can save the Workorder pressing the Save Button (S) or cancel the operation by pressing the Cancel Button (X).

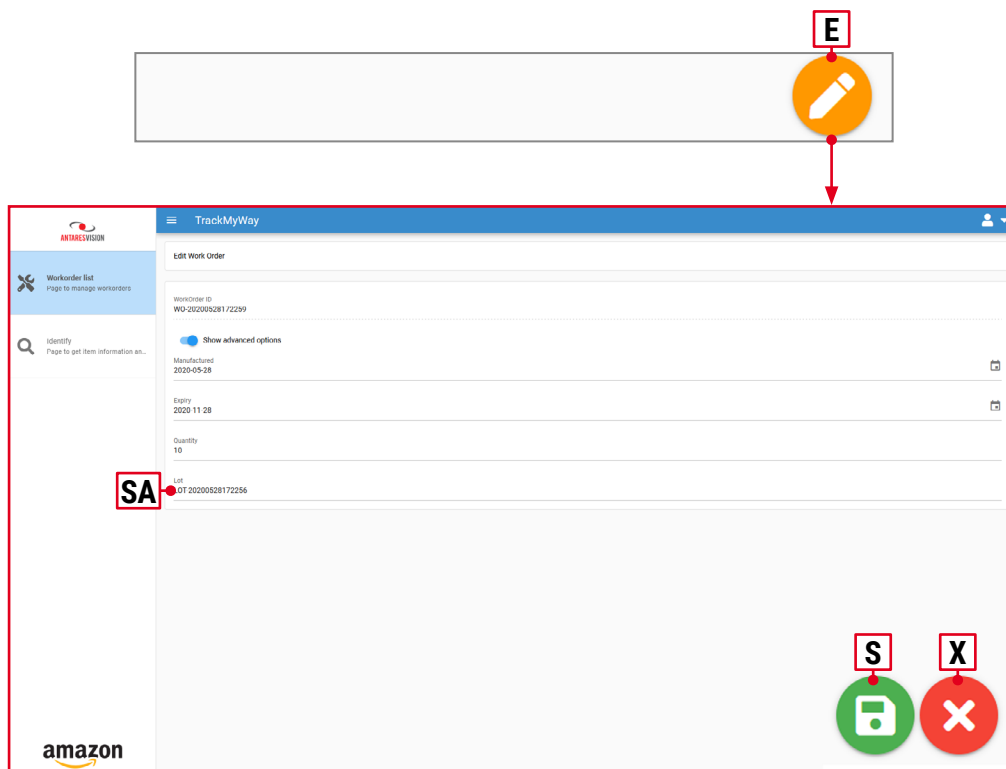

15. AV Transparency Kit / Workorder List / Edit Workorder Page

| ID        | Field Name              | Description  |
|-----------|-------------------------|--|
| <b>C</b>  | <b>Create Workorder</b> | This button allows the user to open the New Workorder page.                                |
| <b>CB</b> | <b>Calendar Panel</b>   | This button open a smart calendar that allows the user to quickly select the desired data. |
| <b>S</b>  | <b>Save Button</b>      | This button allows the user to save the Workorder  |
| <b>X</b>  | <b>Cancel Button</b>    | This button allows the user to cancel the operation and return to the Workorder Main Page. |

**INFO:** This chapter describes all the features of the software, however some may differ based on customer customisation requests.

**INFO:** The images are for illustration purposes only. The software screen may differ according to the customer's customisation requests.

## • CLOSE WORKORDER

In the "Workorder List" page, after opened the Options Panel (O), and pressed the button (C) to Close the selected workorder. After pressing, a confirmation message appears and the user can Cancel or Confirm the operation.

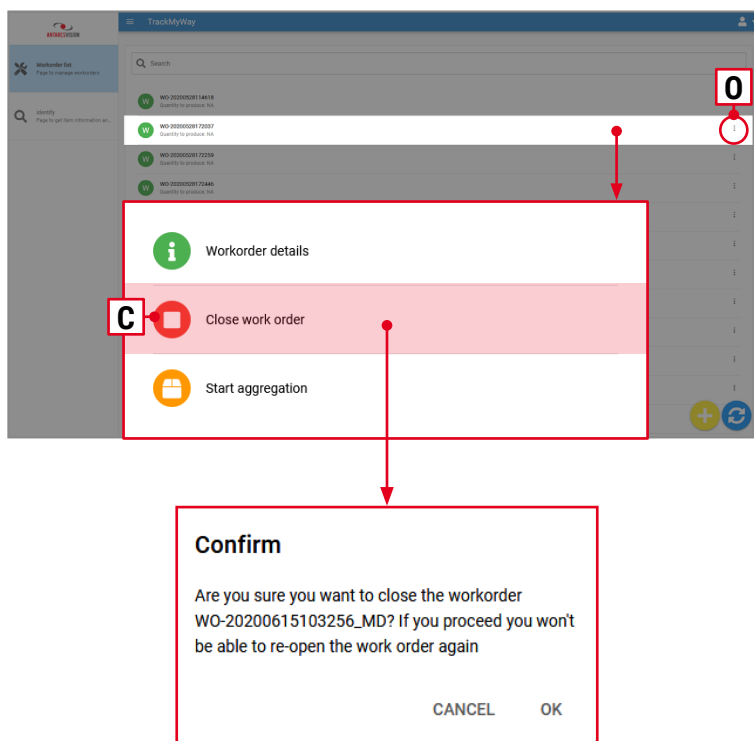

16. AV Transparency Kit / Workorder List / Close Workorder

| ID | Field Name            | Description  |
|----|-----------------------|--|
| E  | <b>Edit Workorder</b> | This button allows the user to open the "Edit Workorder" page, where the user can modify the data. |

**INFO:** This chapter describes all the features of the software, however some may differ based on customer customisation requests.

**INFO:** The images are for illustration purposes only. The software screen may differ according to the customer's customisation requests.

## START AGGREGATION

In the "Workorder List" page, after opening the s Panel (O), press "Start Aggregation" button (S) to open the related page.  
The software allows the user to aggregate items in case. The items can be inserted in a case without geometry control.  
In order to aggregate Items in to container, the Items must not be in another container or already in the process of being aggregated.

The page is composed of a "Input Code" field (IC) that allows the user to scan or manually insert an item code.  
A field (SC) who shows the Workorder ID and the number of added items to current container. In the center there is list that display all the scanned items (CL).

When the user starts the aggregation process the system waits for user to scan unit codes and automatically adds them to container.

The user scans a unit code and repeats operation for each unit code to be aggregated in the same a container.

On every correct scans, the scanner beeps and flashes green.

The "Aggregation Page" displays the list of codes currently being packed inside the container.

At any time, operator can print the case label and close this aggregation by pressing the print button (P).

The system confirms that the container label has been correctly closed and allows for a new container to be created.

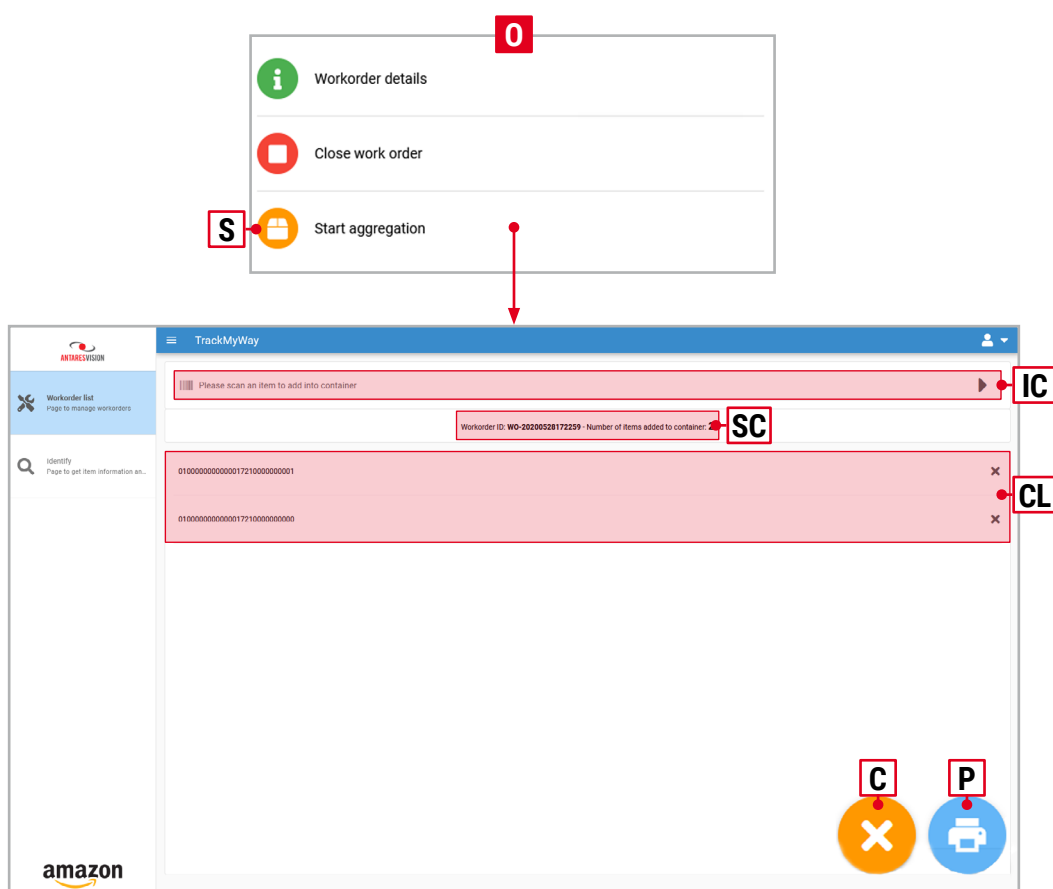

17. AV Transparency Kit / Start Aggregation

| ID | Field Name  | Description  |
|----|-------------|--|
| C  | Cancel      | This button allows the user to Cancel the operation and return to the previous page. |
| P  | Print Label | This button allows the user to print the case label and close this aggregation.      |

**INFO:** This chapter describes all the features of the software, however some may differ based on customer customisation requests.

**INFO:** The images are for illustration purposes only. The software screen may differ according to the customer's customisation requests.

## • VERIFY PAGE

After closing the aggregation, the system shows the "Verify" page.

In this page the user can verify the just printed label by reading the code in the "Input Code" field (IC).

The page is composed of an "Input Code" field (IC) that allows the user to scan or manually insert an item code.

A field (SC) that shows the Workorder ID and the number of added items to current container.

In the center the system show the code of the printed label (PL), so the user can verify it.

By using the Reprint Button (R), the user can also reprint the label (the label its the same, this function is useful if the label has some kind of printing error).

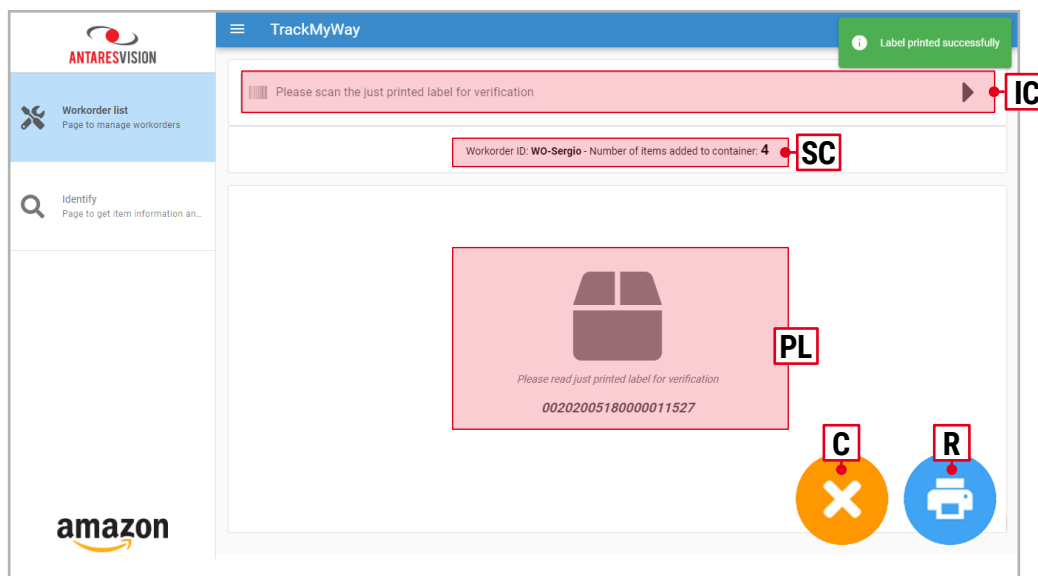

18. AV Transparency Kit / Verify Page

| ID | Field Name  | Description  |
|----|-------------|--|
| C  | Cancel      | This button allows the user to cancel the operation and return to the previous page.   |
| P  | Print Label | This button allows the user to reprint the label (R) (the label is the same, this function is useful if the label has some kind of print error). |

**INFO:** This chapter describes all the features of the software, however some may differ based on customer customisation requests.

**INFO:** The images are for illustration purposes only. The software screen may differ according to the customer's customisation requests.

## IDENTIFY PAGE

In the navigation menu, select the tile "Identify Page" (IP) to access the related page.

The page is composed of an "Input Code" field (IC) that allows the user to scan or manually insert an item code and a field (SC) who shows the code just read.

The "Item Information" field (IF) display the scanned item data and its current status that would be "Verified" or "Rejected".

On the right side, the system display any (if present) child of the scanned item (CP).

In this page the user can:

- Scan an Item or Container and see the status of the item just read.
- Reject a case and cancel the aggregation (C);
- Identify an item and trace back to its parent (S);
- Reprint a label, for item and container (R).

Once identified a code, the user can destroy the aggregation using the "Cancel Aggregation" button (C), reprint the element's Label pressing the Reprint Button (P) or show the Item's hierarchy pressing the "Show Parent" (S) button.

The user can only reject the container in which there are items in "packed" status. By rejecting the container, the items inside return in "Verified" status and so can be reaggregated.

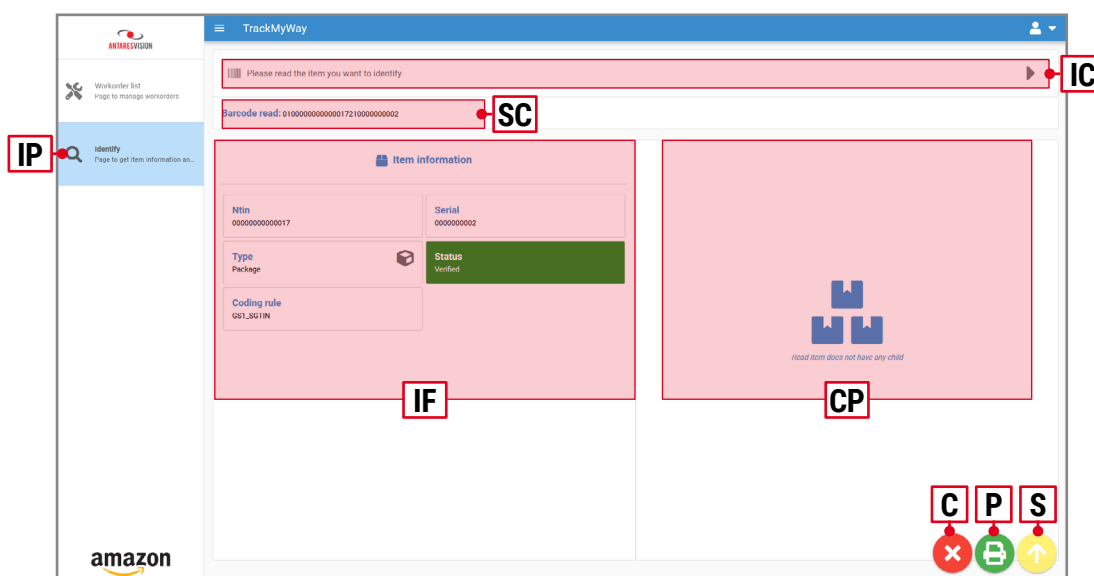

19. AV Transparency Kit / Identify Page / Main

| ID | Field Name         | Description  |
|----|--------------------|--|
| C  | Cancel Aggregation | This button allows the user to destroy the aggregation and put the current element in "Reject" status. |
| P  | RePrint            | This button allows the user to reprint the scanned element's label.                                    |
| S  | Show Parent        | This button displays the element's hierarchy   |

**INFO:** This chapter describes all the features of the software, however some may differ based on customer customisation requests.

**INFO:** The images are for illustration purposes only. The software screen may differ according to the customer's customisation requests.



[illegible]



END OF DOCUMENT



## **ANTARES VISION**

Via del Ferro N.16 - 25039 Travagliato / Brescia / Italia.  
Tel: +39 030 72 83 500 / Fax: +39 030 51 09 958  
[www.antaresvision.com](http://www.antaresvision.com) / [info@antaresvision.com](mailto:info@antaresvision.com)

**[ANTARESVISION.COM](http://ANTARESVISION.COM)**